



eco 

# Catalogue

 **AES**  
GLOBAL



## SLIM Range

Wired Intercom System



- ▶ Hard wired intercom system with stylish, modern indoor handsets in gloss black or white finish.
- ▶ Up to 300m distance on CAT5.
- ▶ Add up to 4 handset per system (Either wall mounted handsfree handset or corded handset).
- ▶ 2 styles of out door station (gloss black facia or metallic look facia).
- ▶ Illuminated push button.
- ▶ Simple install.



Door station voltage - 24v dc  
Handset voltage - 12v dc  
Cores - 3 or 5 wire option  
Max handsets - 4  
Relay - N/O momentary relay with N/C option



# SLIM Range

## Black handsets- Kits & part Numbers



### ECO-SLIM-EB-CL-EU

Gloss black outdoor facia.  
Classic style black handset.



### ECO-SLIM-HF-EB-EU

Gloss black outdoor facia.  
Handsfree style black handset.

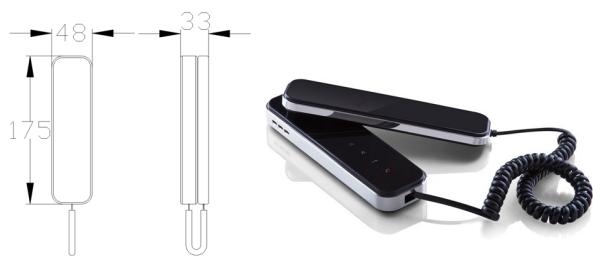

### ECO-SLIM-CL-EH-B-EU

Black corded handset.  
Add up to 3 extra handsets to any kit  
(total 4 per system) for larger homes or  
premises.

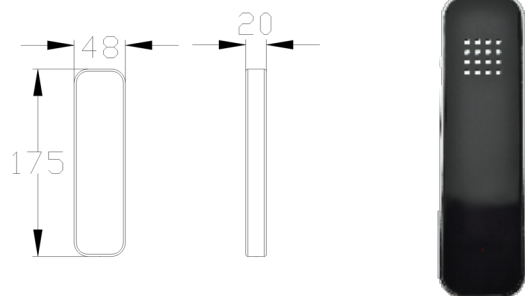

### ECO-SLIM-HF-EH-B-EU

Black Handsfree handset.  
Add up to 3 extra handsets to any kit  
(total 4 per system) for larger homes or  
premises.

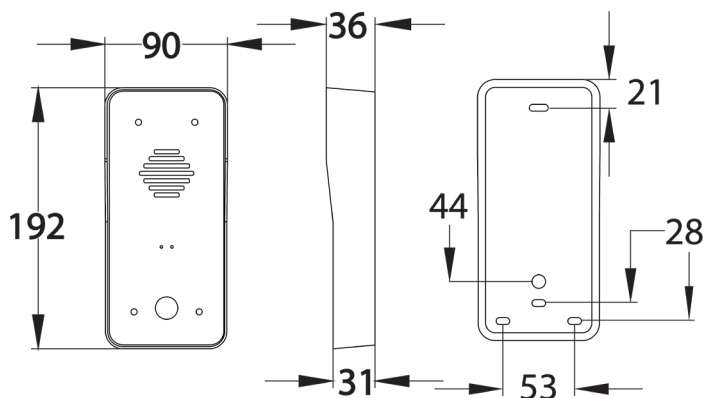

**Area code:**  
**EU** (Europe)  
**US** (USA)  
**AU** (Australia & NZ)

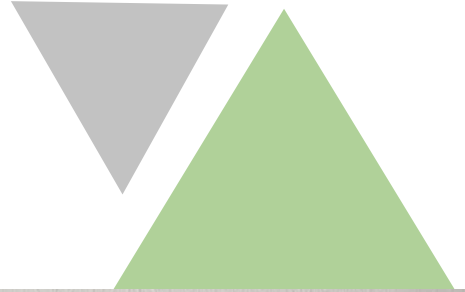



# D.e.c.t 603 Range

Digital Enhanced Cordless Telecommunications



Illuminated Call Button

## Transmitter.



Digital Wireless Signal for Clear Voice



2x Relays



Voicemail Feature for Missed Callers!



Charging Dock

- ▶ Up to 400m open field range.
- ▶ Working range of 200m through 1 exterior wall.
- ▶ Up to 4 handsets per system.
- ▶ Built in voicemail feature to record missed caller messages.
- ▶ Intercall between handsets.



Door station voltage - 24v dc  
Frequency - 1.88GHz  
Max handsets - 4  
2 x relay outputs (N/C & N/O)

# D.e.c.t 603 Range

## Kits & part Numbers



### **ECO-603-EB-EU**

Digital wireless, gloss black facia, portable handset.



### **ECO-603-HF-EB-EU**

Digital wireless, gloss black facia, desk/wall mountable speech unit.



### **603-EH-EU**

Additional handset (add up to 3 additional handsets per system).



### **603-HF-EU**

Additional hands free speech station (add up to 3 additional per system)



**Area code:**  
EU (Europe)  
US (USA)  
AU (Australia & NZ)

# PRIME ECO

Advanced GSM Intercom



- ▶ Calls your home phone and mobiles on roll-over when visitor presses call button.
- ▶ Works with any standard contract or Pre-Pay GSM Nano SIM card.
- ▶ 4G GSM intercom for advanced coverage (4G).
- ▶ **Free** installer app (AES PRO) for remote programming and diagnostics.
- ▶ Free home owner app to trigger gates, set up auto opening and closing times, create new access codes, receive notifications on entry, etc.

4 Dial Out Numbers, 250 permanent caller ID Numbers  
Operating voltage – 12-24v dc  
300mA on dial out, 2amp peak demand  
2 x relay output (N/C & N/O)

# Installer / User App



*FOTA – Upgrade  
firmware via SMS.*



Set automatic  
gate open &  
close times.



2x Relays. Ability to  
check Automatic Relay  
Times.



Ability to check  
Do-not-disturb  
times.



High gain antenna  
as standard! Ability  
to view APN on  
signal level reply.



Illuminated  
call button.



**NEW AES PRO APP, user  
friendly. With Installer and  
homeowner capabilities.**



## Area code:

**EU** (Europe)

**US** (USA)

**AU** (Australia & NZ)

## Kit & part Number

**ECO-PRIME-EB-EU**

2G+3G+4G GSM intercom  
for advanced coverage.  
Gloss black faceplate.

SIM included (UK/IRE only)





# eco *lite*

Simple, Effective GSM Intercom



Antenna built in.



1 X Relay



Illuminated call button.



Puck Antenna as standard.

- ▶ Calls your home phone and mobiles on roll-over when visitor presses call button.
- ▶ Works with any standard contract or Pre-Pay GSM Nano SIM card.
- ▶ 4G GSM intercom for advanced coverage (4G).
- ▶ **NEW free** AES Lite app for installer programming.
- ▶ Homeowner can use app to trigger gates.



*SIM included (UK/IRE only)*

3 Dial Out Numbers, 25 permanent caller ID Numbers  
Operating voltage – 12-24v dc  
100mA on dial out, 220mA peak demand  
1 x relay output (N/C & N/O)

# Installer / User App

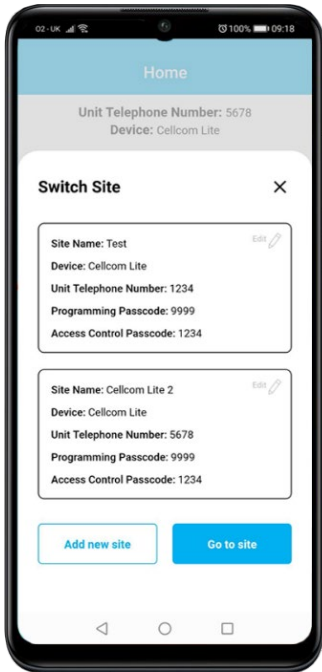

Switch site function for programming and navigating multiple sites.

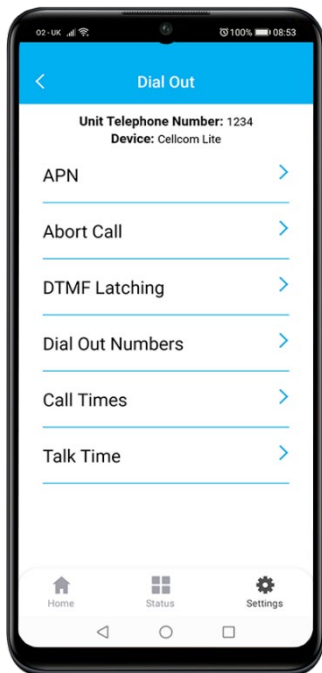

Program dial out numbers and other related features.

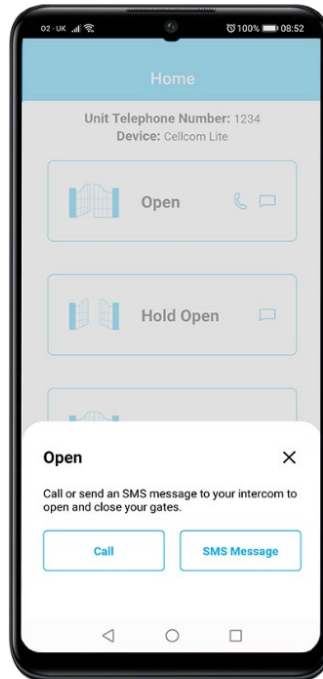

Speed dial or send SMS to control gates.

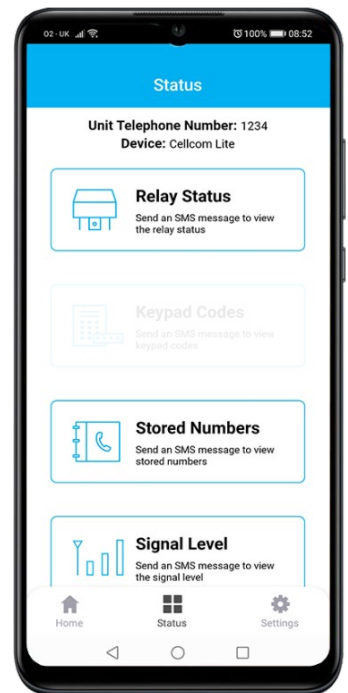

Check stored information and current status of intercom.



**Area code:**  
**EU** (Europe)  
**US** (USA)  
**AU** (Australia & NZ)

## Kit & part Number

**ECO-LITE-EB-EU**

2G+3G+4G GSM intercom for advanced coverage.  
Gloss black faceplate.

SIM included (UK/IRE only)





THE QUEEN'S AWARDS  
FOR ENTERPRISE:  
INTERNATIONAL TRADE  
2021



Follow us on social media!



E. [sales@aesglobalonline.com](mailto:sales@aesglobalonline.com)

TEL. +44 (0) 288 639 0 693